

**BORG034**

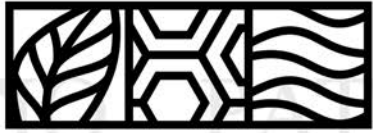

**-BILOCALE-**

CON GIARDINO

CERNOBBIO VIA MONDELLI 34

TOTALI COMMERCIALI: 96 MQ

APPARTAMENTO: 68 MQ

TAVERNA: 30 MQ

GIARDINO: 37 MQ

PREZZO: 495000 €

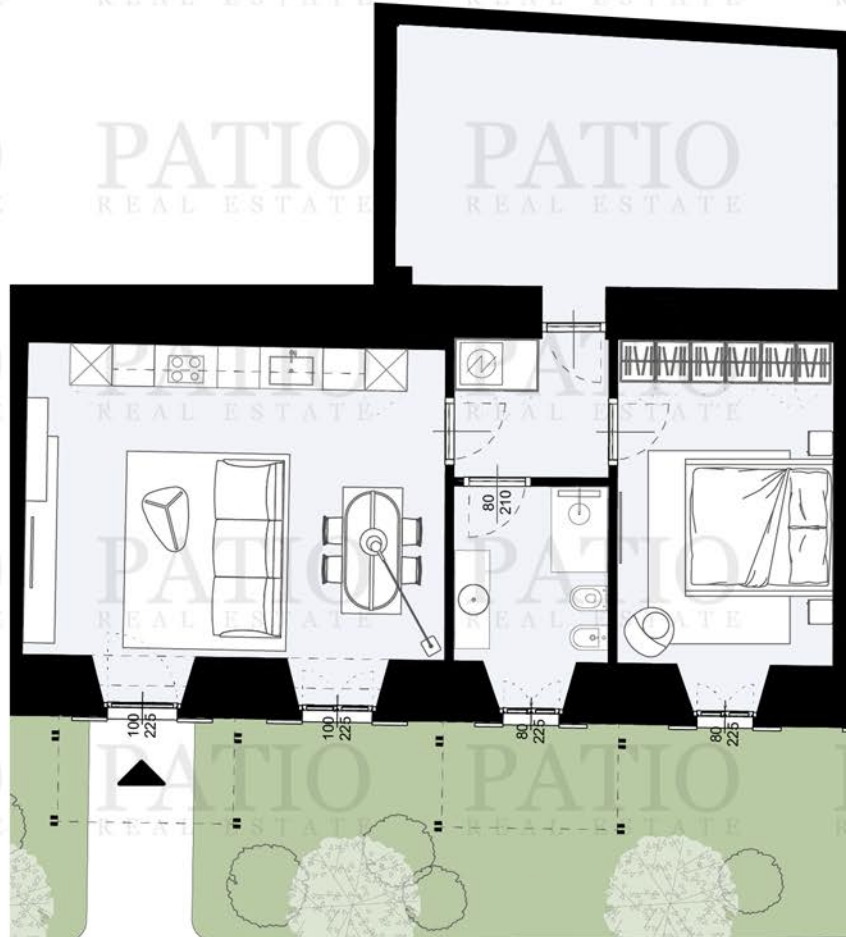

PIANO CORTILE

**DOMUS24**  
DESIGN & BUILDING

**PATIO**  
REAL ESTATE

**PENGUIN**  
DESIGN + BUILDING